

Quick and Easy Robot for Everyone

“MotorModule” makes creating Robots surprisingly easy

KeiganMotor **KM-1U**



The KM-1U KeiganMotor features a high-performance brushless DC servo motor, a motor driver, rotary encoder, and a 6-axis accelerometer-gyro sensor, delivering a maximum torque of 0.3Nm with a power consumption of less than 12W.

As it can be controlled by various devices such as smartphone, Tablet, PC and Raspberry pi etc, You are free to choose development environment.

Option Kit



Camera Kit



Two-wheel drive Dolly Kit



Wheel Kit

All functions fit in the hand

All-in-One Function MotorModule



Quick and Easy Robot for Everyone

The KM-1U is a compact device that combines a high-performance microcomputer, radio, and sensors within 340g. Power consumption too great energy saving with [5V, up to 2.4A] It can output torque of 3 kgf · cm or more. In addition, you can operate with various devices. Such as SmartPhone, Tablet-PC, Raspberry Pi and so on. So you are free to choose the usage that suits your environment. MotorModule has functions with respond flexibly to customer needs.

Diversity that can realize infinite ideas

- Dedicated application that can be easily controlled without specialized knowledge or skill
- "Direct-Teaching" function to memorize movement by hand directly
- Position / speed / torque measurement
- Wireless connectivity
- "Fulfilling option-kits" to create Robot easily

Appearance and Dimensions

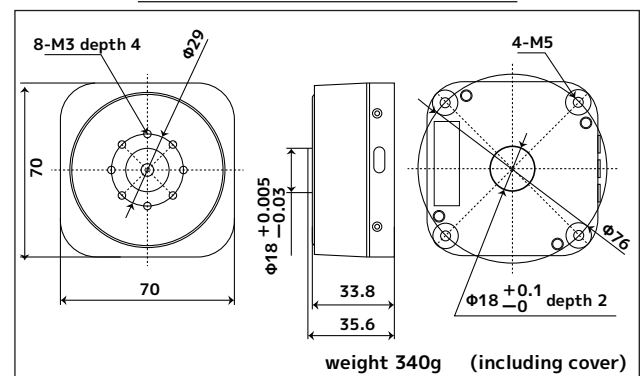

Product specification

Model	KM-1U MotorModule	
Compatible device	SmartPhone, Tablet-PC, PC, Mac and Single board microcomputer etc...	
Power supply (※1)	Voltage and Current : 5V, up to 2.4A Battery : Universal USB Mobile Battery can be used	
Communication method	Wireless : Bluetooth Low Energy Wired : USB (Micro B), I2C Serial communication	
Motor Spec	Constitution	Outer rotor type brushless motor (Permanent magnet synchronous motor) with gearless direct drive
	Max torque	3kgf · cm (0.3 N · m)
	Speed	0.0001~260 rpm (rotation per minute)
	Encoder	14-bit magnetic absolute rotary encoder (0.05 °)
	Sensor	Acceleration, Gyro 6-axis sensor

※1 A "USB type A to C Cable" is included in the products box.

※KM-1 can be upgraded to KM-1U by firmware Ver.2.00 or more.

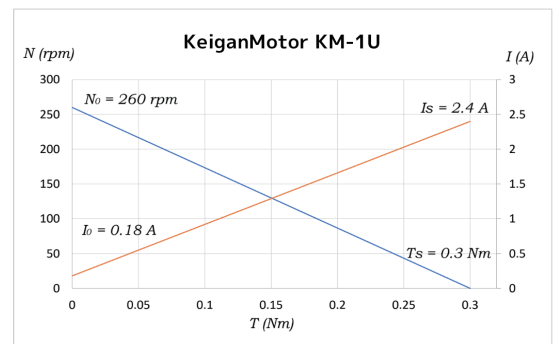

Keigan Inc.
Mail : sales@keigan.co.jp
URL : https://keigan-motor.com/



KeiganMotor can be obtained from the following site.



<https://keigan-motor.com/>

